

Bethany Znidersic

From: Jack Browand
Sent: Wednesday, April 12, 2023 7:50 AM
To: Robert Carola
Cc: Bethany Znidersic
Subject: Re: [EXTERNAL]Eugene Simpson Stadium Park Renovations Proposed In Alexandria | Old Town Alexandria, VA Patch

Thanks for the comment.

Jack

Jack Browand, Deputy Director, Park Services
Recreation, Parks & Cultural Activities
1108 Jefferson St.
Alexandria VA 22314
703.746.5504 (O)
202.497.7452 (C)
www.alexandriava.gov/Recreation
www.alexandriava.gov/SocialMedia

On Apr 12, 2023, at 6:14 AM, Robert Carola rcarola1@amsil.com wrote:

Thank you for including disabled in the plans of Simpson park it means a lot.

Eugene Simpson Stadium Park Renovations Proposed In Alexandria | Old Town Alexandria, VA Patch
Thank you for thinking of the disabled

<https://patch.com/virginia/delray/eugene-simpson-stadium-park-renovations-proposed-alexandria>

**DISCLAIMER: This message was sent from outside the City of Alexandria email system.
DO NOT CLICK any links or download attachments unless the contents are from a trusted
source.**

From: [Jessica Wehrman](#)
To: [Bethany Znidersic](#)
Subject: [EXTERNAL]Simpson baseball
Date: Thursday, April 13, 2023 4:37:08 PM

You don't often get email from jesswehrman@yahoo.com. [Learn why this is important](#)

Hi, Bethany,

I'm writing to offer my strongest possible support of the proposed, long-overdue upgrades to Simpson stadium, and to urge you to begin work on this project as soon as possible.

Years ago, I volunteered for the Little League state championships, and it was an illuminating and depressing glimpse at what needed to be done: People from all over the state came to Alexandria only to find crummy, swampy fields, minimal facilities, no parking and laughably outdated infrastructure. Alexandria is a fantastic place to live. But you'd never know it by looking at Simpson.

I'm currently a baseball mom. I've spent more nights than I can count sitting at Simpson, watching my boy play. Our fields, which serve as the ACHS baseball fields, are of significantly lower quality than virtually every other school we've played against. Our concessions stands are mediocre and remote, the fields themselves are outdated and the press box is....well, not really a press box, if we're being honest. It's more like a hay loft, with no hay.

Visitors to Simpson face little to no parking, the grim reality that if they do find parking, they'll likely have a baseball shatter their windshield, and the joy of juggling against soccer and dog park people in an incredibly limited space. Also, the YMCA might tow you, which doesn't feel very hospitable.

And still, Simpson is the best of the baseball fields in a city that clearly has very low regard for baseball. We were at a Little League game on the West End once when my son, then an elementary school student, had to use the bathroom. With no facilities, he headed toward the woods, as young boys do. I had to gently steer him away from the homeless encampment, telling him he should not pee on that gentleman's home.

If I were to consider moving to a new city at this point in my life and taking into account the public facilities offered by that city, Simpson would not be a selling point. It would be a deterrent. Asking people to buy multimillion dollar homes and send their kids to Little League in something close to Third World facilities is pretty rich. By not investing now in very basic modernization of this park, you are undervaluing your city and possibly repelling people who could contribute to your tax base.

This project was first envisioned in 2014. My son at that point was nine. He's 16 now. I think it's time we get this started - if not for him, for the next generation of young baseball players in Alexandria.

Thank you for your service to the city, and thank you for considering this really important project.

DISCLAIMER: This message was sent from outside the City of Alexandria email system. DO NOT CLICK any links or download attachments unless the contents are from a trusted source.

Bethany Znidersic

From: [REDACTED]
Sent: Thursday, April 13, 2023 11:01 AM
To: Bethany Znidersic
Subject: [EXTERNAL]Support for Eugene Simpson Park Enhancements

You don't often get email from ryan2002harry@gmail.com. [Learn why this is important](#)

Good Morning Beth -

My name is Ryan Harry and I have been a resident of Alexandria City since 2019. Since that time, my children have become heavily involved in Alexandria Little League and hope to one day be a part of the high school baseball program at ACHS. While Simpson Park is a great facility, I believe that the steps to be taken in the Enhancement plan will make it even better and become an envy of other baseball programs in the area.

I wholeheartedly support the plan to enhance Simpson Park for all the following reasons:

- The Simpson Park Improvement Plan was approved in 2014. It is long overdue that these improvements get underway.
- All city baseball programs - Alexandria Little League, Alexandria City High School, Bishop Ireton, and local travel teams - face many field closures each spring due to rain. Often for several days.
- Synthetic turf on Big Simpson and improved natural turf and drainage at Little Simpson will drastically cut down on field closures at those fields.
- Other improvements at the park will enhance the baseball programs as well - improved dugouts, a new dedicated concession stand at Big Simpson, new press boxes and bleachers at both fields, a permanent storage building
- A larger parking area is greatly needed
- Additional enhancements to the park include hardscaped walkways, a planted tree buffer with native vegetation, a picnic and passive area for all to enjoy

I look forward to working with you and your team in this process and will do all I can to support this effort.

Sincerely,
Ryan Harry
Proud Alexandria City Resident and Baseball Dad

**DISCLAIMER: This message was sent from outside the City of Alexandria email system.
DO NOT CLICK any links or download attachments unless the contents are from a trusted source.**

From: [Zak Baig](#)
To: [Bethany Znidersic](#)
Subject: [EXTERNAL]Support for Eugene Simpson stadium park renovation
Date: Thursday, April 13, 2023 11:07:11 AM

[You don't often get email from zak.baig@outlook.com. Learn why this is important at <https://aka.ms/LearnAboutSenderIdentification>]

Bethany - I hope all is well. I live at 1504 Oakcrest Dr, Alexandria VA 22302. I strongly support the renovation project at Simpson park especially the focus on improving the baseball facilities as outlined in the city plan. It's long overdue and much needed improvements. I have 3 kids who love to play baseball and the improvements will greatly improve their ability to be outdoors more often instead of inside.

Additionally I use the dog park often for our dog and believe the improvements won't have an adverse effect on that space.

Thanks and please let me know how I can help.

Zak Baig
1504 Oakcrest drive

Sent from my iPhone

DISCLAIMER: This message was sent from outside the City of Alexandria email system.
DO NOT CLICK any links or download attachments unless the contents are from a trusted source.

From: [Chris Joyner](#)
To: [Bethany Znidersic](#)
Subject: [EXTERNAL]Simpson Field project(s)
Date: Thursday, April 13, 2023 1:14:56 PM

You don't often get email from cajoynerva@gmail.com. [Learn why this is important](#)

Bethany -

My name is Chris Joyner. I'm writing in SUPPORT of the update/modernization project at Simpson Field - with a caveat.

I strongly support improvements at Simpson. They are long overdue. Improvements at the field will help improve the baseball experience at both fields, and improve the parking situation (which is a constant mess).

That said: I HATE the idea of moving Big Simpson Field to artificial turf. They're too hot, destroy the aesthetics of baseball and the stadium, and to be perfectly blunt: my son the baseball player hates playing on fields like that. Please improve the drainage, on the fields (both of them!), but keep them grass and dirt! It can be done - besides, rain is part of baseball and always has been. And keep the green in this city where we can -- its in increasingly short supply.

Thank you,

Chris Joyner
4316 Loyola Avenue
Alexandria VA 22304

DISCLAIMER: This message was sent from outside the City of Alexandria email system. DO NOT CLICK any links or download attachments unless the contents are from a trusted source.

From: [Amanda](#)
To: [Bethany Znidersic](#)
Subject: [EXTERNAL]Support for Simpson Park Update
Date: Thursday, April 13, 2023 3:00:25 PM

You don't often get email from oceanhpu@aol.com. [Learn why this is important](#)

Hi Beth-

I wanted to send you my (and my husband's) strong support for the proposed updates to Simpson Park.

Both of our boys have been playing baseball in Alexandria since they were very young (now 11 and 8) and we rely on the limited fields here to be able to play. When fields such as Simpson can't be used due to too much rain and lack of accommodations for games, practices and events it puts our Alexandria kids at a disadvantage. Not only in the sport, but for opportunities for them to engage in the community and learn critical skills for how to be a productive part of society.

We are dog lovers and have a dog ourselves so we know how important dog parks are to our community, but there is no reason the two have to be in conflict with one another and from what I have read this proposal does that.

I am happy to provide any additional info you need, but please help move this critical proposal forward so we can ensure our youth get more opportunities for engagement, growth and learning versus less.

Thanks,
Amanda Greenwell

~~888-728-8000~~

DISCLAIMER: This message was sent from outside the City of Alexandria email system. DO NOT CLICK any links or download attachments unless the contents are from a trusted source.

From: [Paul Sass](#)
To: [Bethany Znidersic](#)
Subject: [EXTERNAL]Simpson Park Project
Date: Thursday, April 13, 2023 8:53:57 PM

You don't often get email from pauljsass@gmail.com. [Learn why this is important](#)

Good evening, Beth,

I reside at 201 W Walnut St in Alexandria. I have 3 boys that all utilize the city's fields for sports and recreation.

I am very supportive of all efforts to upgrade and modernize our baseball facilities to bring them up to a level of our neighboring communities. More needs to be done to ensure we can access these fields as much as possible (lights, artificial turf, etc).

I also encourage the city to pursue joint ventures to leverage other funding sources to maximize these investments. The community benefits from these facilities and generates activity of all sorts. From our local rec department, little league, travel ball and our highschoools the needs are great. As a coach in little league and with the rec leagues I've experienced that difficulty in accommodating all the needs for these fields.

These field upgrades are desperately needed and I appreciate your continued support to see them to completion. Thank you.

Paul J. Sass

DISCLAIMER: This message was sent from outside the City of Alexandria email system. DO NOT CLICK any links or download attachments unless the contents are from a trusted source.

From: [Lisa Dougherty](#)
To: [Bethany Znidersic](#)
Subject: [EXTERNAL]Simpson Park Renovation
Date: Sunday, April 16, 2023 10:39:10 AM

You don't often get email from lisa.dougherty30@gmail.com. [Learn why this is important](#)

Ms. Znidersic -

I understand that you are the Manager of this project for the City. Therefore, I write today to show my 100% support for this proposed project and hope work starts this spring.

As a family with two sons that played youth baseball in Alexandria, it is critical that these improvements occur to both eliminate weather headaches during the fall and the spring, but more importantly to keep community-focused Alexandria alive. Even if you are not a baseball family, baseball games make everyone smile. Name one person that walks by Simpson field when games are being played that doesn't observe.

The only thing that some may suggest is a negative to the plan is the reduction of the dog park. As a dog owner and lover and someone who has used the park often, I can say that it is worth a little less space for the greater good of the entire area. And..the City has installed another dog park already steps away on Monroe Avenue.

The park has also looked a little neglected for years and the proposed plan will additionally enhance the green space around the fields. With all the housing development occurring in the City, it's time that the City focuses on what really makes Alexandria great - community and green space - not mixed-use high rises.

Lisa Dougherty

DISCLAIMER: This message was sent from outside the City of Alexandria email system. DO NOT CLICK any links or download attachments unless the contents are from a trusted source.

From: [GEORGIA ANASTASIOU](#)
To: [Bethany Znidersic](#)
Subject: [EXTERNAL] Trees - Eugene Simpson Park Renovation Projects
Date: Sunday, April 23, 2023 8:50:42 PM

Hello Ms. Znidersic:

Out of the 6 trees I identified in the attached picture - which trees will be cut down for the renovation and if any will be cut down what will be placed there instead?

Sincerely,
Georgia

DISCLAIMER: This message was sent from outside the City of Alexandria email system.
DO NOT CLICK any links or download attachments unless the contents are from a trusted source.



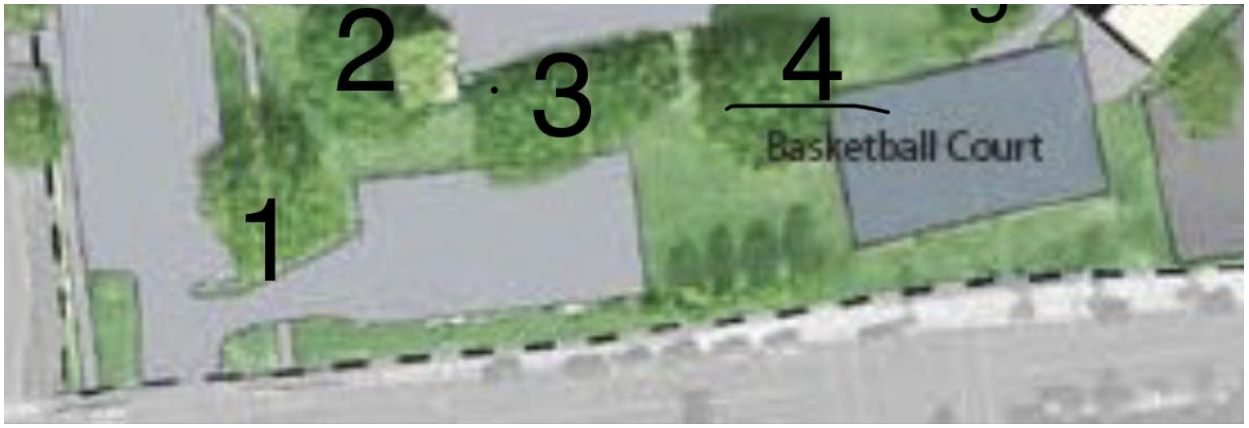

From: [Brian Collins](#)
To: [Bethany Znidersic](#)
Subject: [EXTERNAL]Simpson Field Renovations
Date: Sunday, April 30, 2023 9:53:50 PM

You don't often get email from brian.c1@me.com. [Learn why this is important](#)

Hi Bethany, I hope you had a good weekend.

I was unable to make the public session last Wednesday and wanted to get clarification on a couple things.

Some of my neighbors went and they said the plastic turf that may go in will have drainage underneath that will soak into the soil. My understanding is that all of the drainage from the plastic fields will go into pipes that drain into the city water drainage system not the soil - how would you describe what happens to the water that lands on plastic fields contemplated for Simpson Field?

Much of the land at Simpson Field is used for soccer matches. Does this phase include any plans to install plastic grass or otherwise modify the soccer fields - based on what I see in the graphics it does not - that would be some other phase. If the soccer fields are not included does this phase currently up for discussion affect planning for future phases of the soccer fields?

During a recently hot day this Spring I compared the temperatures at GW Middle School dirt/grass fields and they were about 79 degrees F and when I went to Jefferson-Houston plastic fields the turf temperature was 124 about 55 degrees hotter. Is this taken into account during your planning that fields may be or will be too hot to play on during hot summer days or hot days that pop up?

My research of plastic grass (artificial turf) fields shows that they contain forever chemicals - PFAS type. What mitigations or research is the city doing to ensure we are not poisoning our kids with chemicals - and our adults too by installing plastic fields? I recently (about 10+ days ago) sent a question to 311 asking if the plastic fields in Alexandria contain PFAS and have not received an answer.

Do we or do you publicly discuss the cost of the plastic fields vs. installing or modifying the grass fields? What I understand is plastic fields have about a 10 year life span only.

<https://www.alexandriava.gov/parks/project/eugene-simpson-athletic-diamond-fields-renovation-plan>

Thanks in advance for your coordination. I appreciate you taking the time to canvass the community and get public feedback.

Thanks, Brian

~~XXXXXXXXXX~~

~~brian.c1@me.com~~

DISCLAIMER: This message was sent from outside the City of Alexandria email system. DO NOT CLICK any links or download attachments unless the contents are from a trusted

source.

From: [Janae Bixby](#)
To: [Bethany Znidersic](#)
Cc: [shawnbixby1](#)
Subject: [EXTERNAL]Simpson Park Modifications- Summary of conversation from community outreach (current park-adjacent resident)
Date: Monday, May 1, 2023 1:01:52 PM
Attachments: [image.png](#)
[Park pedestrian safety.png](#)

You don't often get email from janae.bixby@gmail.com. [Learn why this is important](#)

Bethany,

Thanks for taking time to meet with residents and dog park users last week for feedback about the park plan. I know that must have been an extremely stressful position to have been in.

There are a few points I wanted to follow up on. Sorry this email is so long and I am writing it in a rather rushed manner.

(1) DOG PARK SIZE: Once land is removed from the dog park, it's permanent. The dog park users will never get the opportunity to reclaim that in this lifetime. It feels unfair to take that away from users who use that feature every day, throughout the day, year round, for fields that get used a few times a week, during certain seasons, for paid usage, only in the evening. Alexandria developed this part of the neighborhood (and now Potomac Yards) with almost no open property designated for each townhome lot- the park is all most of the residents on this side of the neighborhood have for their dog. That feels very unbalanced. Especially just to provide a few additional parking spaces and larger baseball fields. I understand the baseball field is not as large as regulation, but it's working. No kid isn't getting into college because their field wasn't regulation size. Can the field size be increased without moving the basketball courts? There's nearly nowhere left for dogs to be off-leash in this region. Like the dog park contingency stated, Alexandria is not known for having adequate dog parks and people find Arlington much more attractive due to their park structure.

(2) Regarding lengthening the parking lot: Why not lengthen it for those additional spaces, but just create a single entrance like there is now, so no need to move the basketball courts because now you don't need to align an exit with the intersection? The parking lot is small and there haven't been serious safety issues. 15 spots is not going to nearly solve the parking problem. But, you can still add extra spots even if it only has one entrance/exit, right? Why not widen the single exit/entrance instead? Can YMCA give up a single parking spot to help the city widen the entrance to that lot? Also, please please please open up the other side of E Bellefonte Ave. for parking. You will gain MORE than 15 spots by doing that, and help with a severe speeding problem we experience on the 400 and 500 block of Bellefonte (because the street is so wide and there are no stop signs for 3 blocks, cars just speed down this portion). Additionally, you are implementing paths on the north side of the park because you want to provide additional access to the park from this side of the neighborhood, right? So why not provide additional parking on this side of the neighborhood as well? See next point #3.

(3) PEDESTRIAN SAFETY FOR PARK ACCESS ON NORTH SIDE: Regarding safety of Bellefonte, I've tested it, even my minivan can go 45 mph over the speedbumps without issue. The speedbumps were a spectacular failure. That intersection of Duncan and Bellefonte ave has seen so many near accidents, it also needs to be a 3-way stop. The cars turning onto bellefonte from Duncan can't see the speeding cars coming down Bellefonte until it's already too late. Also the cars don't stop for pedestrians crossing at that intersection (and there is no crosswalk at La Grande and Bellefonte, so EVERYONE crosses at Duncan and Bellefonte who is cutting through the park to get to the US-1

crosswalk to get to the metro bus stop (and everyone who needs to get to the park and Duncan). I have been, by no exaggeration, nearly hit several times while pushing a stroller and walking my dog that I had to scream out-loud to get the cars to stop. Because car's are parked so close to the intersection, turning cars don't see you and they are going fast because they don't have to stop to turn there. We need to slow it down, opening double sided parking solves many problems.

If the city wants people to access the park from the North end by these new paths, there will need to be a safe way for pedestrians to cross from one side of Bellefonte to the other from farther up in Del Ray (near La Grande), not just down by US-1. We need a 3-way stop and crosswalk at Duncan/Bellefonte to make sure the paths in the north part of the park aren't increasing the pedestrian crossing problem at Bellefonte and Duncan. Seems short sighted to worry about the safety in the parking lot by the baseball fields at the park but not worry about pedestrian safety on Bellefonte for park-goers.



(4) VISUAL BARRIER ON NORTH END OF PARK TO US-1: Regarding the low level tree and bush barrier on the north end of the park, I challenge your team to come sit there for a bit during the day, and ESPECIALLY for a bit after sun-down. Then hop to the other side of the bushes and tell me, do you feel calmer on one side than the other? Now imagine being that close to US-1 traffic all day. The visual barrier between the homes and the street is SO significant. Especially in the evening with blinding car headlights and taillights 24 hours a day. Just like the other architect mentioned, his friend lives across the street and told him nobody uses that park because of the traffic immediately adjacent- its just not pleasant. EXACTLY. Now WE (nearly 30 homes) will be forced to experience that 24 hours per day if the low barrier is removed. The argument that US-1 used to be immediately adjacent to these homes is not a valid argument on why visual barriers can be removed now. None of us bought these homes with US-1 directly in our "backyard." Additionally, I'm sure you've seen the view of the back of our row homes. It's not pleasant. Honestly we are some of the lower income homes in the area, and the backyards reflect that. I don't think most will enjoy walking around with the view of our trash-can filled alley.





Providing some barrier between the edge of the park and the alley will (a) create a nicer view for those using the paths (b) create a nicer view from US-1 (c) create a visual and sound barrier between the homes and US-1 (d) provide some level of privacy so our homes are not targeted by those on US-1 and through the park. The city states these paths are being added to provide access to those on the north side of the park to the fields, but do we really want to encourage them to have access to this neighborhood alley and potentially increase opportunities for theft from our yards?

Additionally, the closer the lower bushes/trees are to the alley side of the park (vice the US-1 side), the larger the visual impact will be to protect the view, since laws of perspective show that things that are closer together block out more of a view. If the trees and bushes line US-1 side, they won't have the same size-impact. I was out in Fairfax this weekend and came across this small example of a visual barrier. Additionally these were installed on a mound. I will send video through separate correspondence from my cell. I know that installing extra bushes and trees will cost more money, but to protect this street of homes, I urge you to consider the benefits to everyone including those who actually live here. I believe this photo includes arborvitae trees. It's also a good opportunity for native grasses or other native bushes.



(5) ALLEY WIDTH: The alley behind Duncan is narrow, plan to deal with the trash truck tires as they do not fit in the alley. We had a small edge lined it that is degrading, but if trash truck isn't accounted for, it may ruin new features you install and create ruts that retain mosquito infested pooled water. I had to fight very hard back in 2015 or 2016 to get this installed



(6) BATTING CAGES DANGEROUS TO BIRD LIFE: the batting cages trap large birds of prey, this has happened countless times. Those of us who use the park during the day often have to deal with this by calling a rescue society and tracking down someone to unlock the cages. It's getting emotionally exhausting. There must be a way to include a fenced grate on the top with chain link small enough to prevent owls and hawks from coming in above and getting tangled in the netting while trying to catch smaller birds which go in and out without issue. Often dog park users are also the ones who end up dealing with this issue since they are right next to it. But it also happens in the batting cages on the north side as well near the maintenance sheds.

(7) DANGEROUS TREES NEAR PLAYGROUND: There are what I believe are Honey Locust trees on the edge of the retention area just outside the YMCA along Duncan. Here are some photos. Does the YMCA own them or the city? They are spreading and are getting close to the sidewalk and are adjacent to the playground area. These trees spread and need to be dealt with. See highlighted yellow area below.

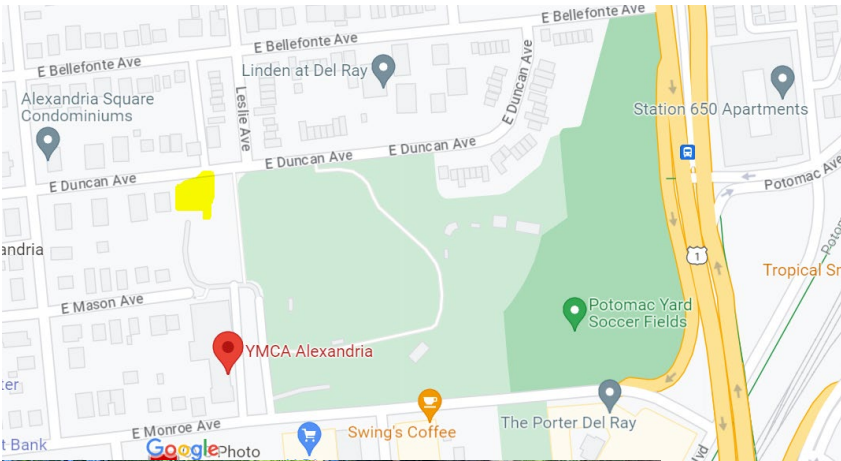

Standing at corner of playground facing direction of honey locusts trees with thorns



Here you can see the YMCA in the distance. The honey locusts are on the right behind the SUV.



Close up of several honey locusts at that location



close up of thorns



These are some of the smaller sapplings within hands reach of the sidewalk. Not sure if its the same tree spreading or a whole different thorned tree/bush, but they are growing more and more in the last few years.



Honey locusts along edge of this retention area and next to the private lot just to the right.

Thanks for reading.

Janae Bixby

I can be reached at ~~(703) 461-9221~~ if you want to discuss more.

**DISCLAIMER: This message was sent from outside the City of Alexandria email system.
DO NOT CLICK any links or download attachments unless the contents are from a trusted
source.**

From: [Janae Bixby](#)
To: [Bethany Znidersic](#)
Subject: [EXTERNAL]Low visual barrier example for model on North Side of Simpson fields
Date: Monday, May 1, 2023 1:05:47 PM
Attachments: [Video.mov](#)

[You don't often get email from janae.bixby@gmail.com. Learn why this is important at <https://aka.ms/LearnAboutSenderIdentification>]

Hi Bethany,

I sent an email from my laptop but typed your email wrong, then forwarded it to your correct email. I hope the full message came through, let me know if it seems truncated. It was reiterating some points from last weeks Simpson meeting and includes some examples and photos and some safety issues I didn't bring up last week.

Second, here's a video of an excellent example of a low visual mounding barrier that could be used near the alley on the north end of the park to immediately help current residents from feeling the impact of removal of the invasive bushes and trees.

DISCLAIMER: This message was sent from outside the City of Alexandria email system.
DO NOT CLICK any links or download attachments unless the contents are from a trusted source.

- Janae Bixby

~~XXXXXXXXXX~~

Sent from my iPhone

From: [Janae Bixby](#)
To: [Bethany Znidersic](#)
Subject: [EXTERNAL]Fwd: Call.Click.Connect. #98360: Park Maintenance
Date: Monday, May 1, 2023 1:14:06 PM

You don't often get email from janae.bixby@gmail.com. [Learn why this is important](#)

Here's the history of the alleyway width expansion. I don't have the pictures still. The siding that was added is already degrading.

Janae Bixby

----- Forwarded message -----

From: Call.Click.Connect. <CallClickConnect@alexandriava.gov>
Date: Sun, Jun 5, 2016 at 2:29 PM
Subject: Call.Click.Connect. #98360: Park Maintenance
To: <janae.bixby@gmail.com>

Dear Janae Bixby,

Thank you for contacting the City of Alexandria. Your request has been submitted. The details of your request are outlined below. If you wish to update this request or provide additional information, please call 703.746.HELP (4357), Monday – Friday, 8 a.m. to 5 p.m. (except **closed** 2 p.m. to 4 p.m. on the third Wednesday of each month), and a Call.Click.Connect. representative will assist you.

You may [check your ticket status online](#).

Call.Click.Connect.
YOUR GOVERNMENT @ YOUR FINGERTIPS!

Request Details:

- Approximate Address: No Address Specified
- Request ID: 98360
- Request Type: Park Maintenance
- Request Description: In the alley pictured in the attachment that runs along Simpson Park (starting at the homes between the rear of 519 E Bellefonte Ave and left side of 547 Duncan Ave, running parallel to Duncan Ave, and then exiting on Duncan Ave between the tennis courts and the side of 501 Duncan Ave), there are numerous areas that have been deeply gouged by the dump truck. After a rain, the ground is moist and easily gives way when a heavy dump truck drives on it. The dump truck that comes to pick up trash cannot fit in the alley because it is paved too narrow in many areas. So the dump truck has to drive on the grass in some areas. This causes deep gouging into the ground and over time, and these pits are wide and deep enough to keep water after a rain for up to a week, even in hot and dry conditions post-rain. The water sits for so long before evaporating it grows algae.

This is a serious public health and safety issue because these pools are breeding havens for mosquitos. One dog has already contracted Parvo from these pools of water and potential rats in the water. Coming from Florida, I can easily say this is the worst and most mosquito ridden neighborhood I have ever lived in.

This is an issue not only for the residents who live in the surrounding blocks, but also for the children and parents (many pregnant) who spend time in the sports fields DIRECTLY NEXT TO this area. The mosquitos infest these areas. There isn't anything residents can do to prevent this. We can spend all of our efforts making sure our yards are free of standing water, but can do nothing to keep these pits dry. My husband has tried to put mosquito tablets in these at our own expense, but there are too many of them to keep up with and this is extremely dangerous for dogs and pets in the area should they drink the water.

This is a serious health issue with the looming Zika Virus threat and the city should treat this as the safety issue that it is. The residents in this neighborhood have contacted the city about this problem many times, with no action on the city. My husband has tried filling pits with gravel, but the weight of the dump truck again just pushes these down and pack into the ground, creating new pits

With all of the work that will be accomplished on the parks near the alley, this work should be extended to officially pave the alley to widen it. The alley has the space to be paved, it just needs to be paved. It was originally paved too narrow for the truck. This alley is also used by many to access Simpson Park.

The pictures included below are all from different and distinct areas along the alley. The gouges are as deep as 3 or more inches in different areas. These pictures were taken 4 days after a previous rain, and there had been three 90+ degree days in a row, with significant water left.

Mosquito facts:

- It only takes 24-48 hours for mosquito larvae to hatch once laid. Within the next 7 days, they develop and emerge as a full adult.
- Mosquitos can fly for miles. Females lay 100 eggs at a time.
- With relevance to the Zika virus, edes aegypti mosquitoes lay eggs on the walls of water-filled containers. Eggs stick to containers like glue and remain attached until they are scrubbed off. The eggs can survive when they dry out—up to 8 months. When it rains or water covers the eggs, they hatch and become adults in about a week.
- When water is contaminated with organic matter (for example, human or animal waste, grasses, and leaves), the chances that mosquito larvae will survive may increase because contaminated matter provides food for larvae to eat.

I want to emphasize that the images attached are 4-5 DAYS after rain, with consecutive 90+ degree days in between. As you can see, the water is still far from being gone. This is a health and safety issue. This is a CONSTANT situation throughout the summer (and even late fall and winter, when water gets trapped and remains frozen for long periods of time in slippery pools). Many women in the townhomes surrounding this alley are pregnant.

- Phone Number: ~~202-459-3970~~

- Email: amc@alexandria.gov
- Attachment: [Alley Mosquitos.pdf](#)

DISCLAIMER: This message was sent from outside the City of Alexandria email system.
DO NOT CLICK any links or download attachments unless the contents are from a trusted
source.

From: [Janae Bixby](#)
To: [Bethany Znidersic](#)
Subject: [EXTERNAL]Fwd: Alley pics 1
Date: Monday, May 1, 2023 1:15:54 PM

You don't often get email from janae.bixby@gmail.com. [Learn why this is important](#)

Oh, I did find the original photos from 2015/2016 of the alley. This is caused by the garbage trucks.

----- Forwarded message -----

From: Janae Bixby <[\[REDACTED\]@gmail.com](mailto:janae.bixby@gmail.com)>
Date: Sun, Jun 5, 2016 at 1:58 PM
Subject: Alley pics 1
To: Janae Bixby <[\[REDACTED\]@gmail.com](mailto:janae.bixby@gmail.com)>

Sent from my iPhone

Sent from my iPhone

**DISCLAIMER: This message was sent from outside the City of Alexandria email system.
DO NOT CLICK any links or download attachments unless the contents are from a trusted
source.**

From: [Catherine Barry](#)
To: [Bethany Znidersic](#)
Subject: re: Eugene Simpson Athletic Diamond Fields Renovation Plan
Date: Tuesday, May 2, 2023 4:17:06 PM

[You don't often get email from [REDACTED]. Learn why this is important at <https://aka.ms/LearnAboutSenderIdentification>]

I am concerned that your plan does not mention the garden on the westside of the large ball field. The Simpson garden is lovely but there is only one bench and there is no hardscape where someone could park a wheelchair or a baby stroller. One of my elderly neighbors visited Simpson every day during COVID lockdown for his mental health but was not able to take his wife with him who was not as mobile. I think it would be a very minor change to the overall plan to add to the garden some ADA features.

From: [Matthew Weihmiller](#)
To: [Bethany Znidersic](#)
Subject: [EXTERNAL]
Date: Thursday, May 4, 2023 1:00:56 PM

You don't often get email from mweihmiller@hotmail.com. [Learn why this is important](#)

Bethany,

I wanted to reach out to you to follow up the recent community meeting re: the Simpson Park improvement plan. I wasn't able to attend the meeting but have spoken with neighbors since. I'm disappointed to hear that one of the sides of the existing dog park is to be reduced by 8' to accommodate a larger parking lot entrance/exit. More troubling is the proposed removal of several large, older trees that border it. I would implore the City to protect these trees; in short we need more rather than less greenery and trees as they are critical to our enjoyment of outdoor activities as well as our overall well being, not to mention their ecological importance. In short, will the City please re-consider this plan?

Also, more pressing, since the dog park was closed, there has been an explosion in dog owners who walk their dogs off-leash in the public green space between the Duncan Ave alley, new soccer fields, and Little Simpson baseball diamond. In fact, someone brings his dogs each night and opens the gate to allow his dogs to run in the soccer fields in violation of the signage. My family and I are dog owners/lovers as well, however, I'm concerned for my dog's as well as my family's safety should an unleashed dog confront or chase us and our dog. Can the City patrol this more actively and/or place signs to remind people that the leash laws haven't been suspended just because the dog park is closed?

Thanks,

Matthew Weihmiller, 521 E. Duncan Avenue.

"so you have every right to your gullibility and I won't try to deprive you of it, but personally, I'd rather know what the hell is going on" (E. Spiers)

DISCLAIMER: This message was sent from outside the City of Alexandria email system. DO NOT CLICK any links or download attachments unless the contents are from a trusted source.

From: [Nicole Radshaw](#)
To: [Bethany Znidersic](#)
Subject: [EXTERNAL]Support for upgrade of Simpson park and fields
Date: Monday, May 8, 2023 11:16:31 AM

You don't often get email from nicole.radshaw@gmail.com. [Learn why this is important](#)

Dear Ms. Znidersic,

I am writing to you in support of the upgrade and development at Simpson Park. While I live over on the West End, my son used to play baseball there, and now he plays soccer. And while that happens, my dog likes the dog park! But, I know that plenty of other community members and not just my family use that park for activities.

While I love trees and nature, I recognize that sometimes we need to chop some down in order to grow and improve our amenities. We can plant other trees in other places. But we can't easily build a new ball park somewhere else. Simpson was included in the City wide Park development plan from 2014. I am glad we are getting to it. New bleachers will be great for parents, friends, and grandparents to watch their kids play. Having a new nice concession stand will allow teams to raise money- and teach kids some work ethic. And turf is so important with so many games being played and rainy springs challenging the sports schedule.

I am happy to see bike racks in several locations on the plan. You can always add more!

Thank you for your work! I support the improvements at Simpson Park. I can't wait for the soccer fields to be next ;)

Sincerely,
Nicole Radshaw
5340 Thayer Avenue
Alexandria, VA 22304

DISCLAIMER: This message was sent from outside the City of Alexandria email system. DO NOT CLICK any links or download attachments unless the contents are from a trusted source.

From: [A.S](#)
To: [Bethany Znidersic](#)
Subject: [EXTERNAL]belated comments for Eugene Simpson renovations
Date: Monday, May 8, 2023 10:04:17 PM

You don't often get email from astipkala@gmail.com. [Learn why this is important](#)

Hello Bethany,

I hope you accept my belated comments- I am a homeowner in the 500 block of Duncan Ave so I am directly impacted by this project. (I'm also a mother on my own with two kids so time got away from me).

I wanted to comment on a few things that were not clearly spelled out or lacking in the design plan:

1. What happens to the existing trees near the alleyway along Kettle Park? Are they left there and additional trees are planted? Currently, the trees there provide an exceptional sound barrier as well as privacy from Route 1 for the residents of this block, as they are leafy from top to bottom. I worry about these trees being removed in favor of smaller trees (such as those near the Potomac Ave playground) which take years to grow and provide little shade or privacy. The trees also provide a nicer view than looking toward the apartments across Route 1. Lastly, two of the trees are flowering from top to bottom and provide beautiful scenery when in bloom in the spring. Tearing these down would be an incredible loss.

2. Kettle Park should be enclosed with fencing and/or a barrier of trees such as arborvitae along Route 1. The sound from traffic is extremely loud and the park is incredibly uninviting for families, not only due to the sound but due to the lack of any safety barrier along the road. We live right there and are not inclined to throw a ball or do anything except for having a picnic very close to the existing trees. Providing a natural or man-made barrier to the road would make the park more useful for a variety of people, and a more serene place to spend time. I occasionally see dog walkers in the park but never see any families using this space as I'm sure they have similar sentiments about safety and noise. It misses the mark to create paths without addressing the bigger picture of this park being along a major thoroughfare.

Thank you. I would appreciate it if you are able to confirm receipt.

Alexa Stipkala

DISCLAIMER: This message was sent from outside the City of Alexandria email system. DO NOT CLICK any links or download attachments unless the contents are from a trusted source.

From: [A S](#)
To: [Bethany Znidersic](#)
Subject: [EXTERNAL]belated comments for Eugene Simpson renovations
Date: Tuesday, May 9, 2023 8:54:58 AM

You don't often get email from astipkala@gmail.com. [Learn why this is important](#)

Hello Bethany,

I am not sure if my prior message went through so I apologize if this is a duplication.

I hope you accept my belated comments- I am a homeowner in the 500 block of Duncan Ave so I am directly impacted by this project. (I'm also a mother on my own with two kids so time got away from me).

I wanted to comment on a few things that were not clearly spelled out or lacking in the design plan:

1. What happens to the existing trees near the alleyway along Kettle Park? Are they left there and additional trees are planted? Currently, the trees there provide an exceptional sound barrier as well as privacy from Route 1 for the residents of this block, as they are leafy from top to bottom. I worry about these trees being removed in favor of smaller trees (such as those near the Potomac Ave playground) which take years to grow and provide little shade or privacy. The trees also provide a nicer view than looking toward the apartments across Route 1. Lastly, two of the trees are flowering from top to bottom and provide beautiful scenery when in bloom in the spring. Tearing these down would be an incredible loss.
2. Kettle Park should be enclosed with fencing and/or a barrier of trees such as arborvitae along Route 1. The sound from traffic is extremely loud and the park is incredibly uninviting for families, not only due to the sound but due to the lack of any safety barrier along the road. We live right there and are not inclined to throw a ball or do anything except for having a picnic very close to the existing trees. Providing a natural or man-made barrier to the road would make the park more useful for a variety of people, and a more serene place to spend time. I occasionally see dog walkers in the park but never see any families using this space as I'm sure they have similar sentiments about safety and noise. It misses the mark to create paths without addressing the bigger picture of this park being along a major thoroughfare.

Thank you. I would appreciate it if you are able to confirm receipt.

Alexa Stipkala

DISCLAIMER: This message was sent from outside the City of Alexandria email system. DO NOT CLICK any links or download attachments unless the contents are from a trusted source.

From: [Mike French](#)
To: [Bethany Znidarsic](#)
Subject: [EXTERNAL]Is this true?
Date: Friday, May 12, 2023 5:52:03 PM

[You don't often get email from [\[REDACTED\]](#). Learn why this is important at <https://aka.ms/LearnAboutSenderIdentification>]

We are losing enough of these old trees already. What a terrible idea if so.

An Alexandria resident,

Mike

DISCLAIMER: This message was sent from outside the City of Alexandria email system.
DO NOT CLICK any links or download attachments unless the contents are from a trusted source.



Mike French

~~XXXXXXXXXX~~