

Alternative 2: One-Way Traffic & Bus Lane

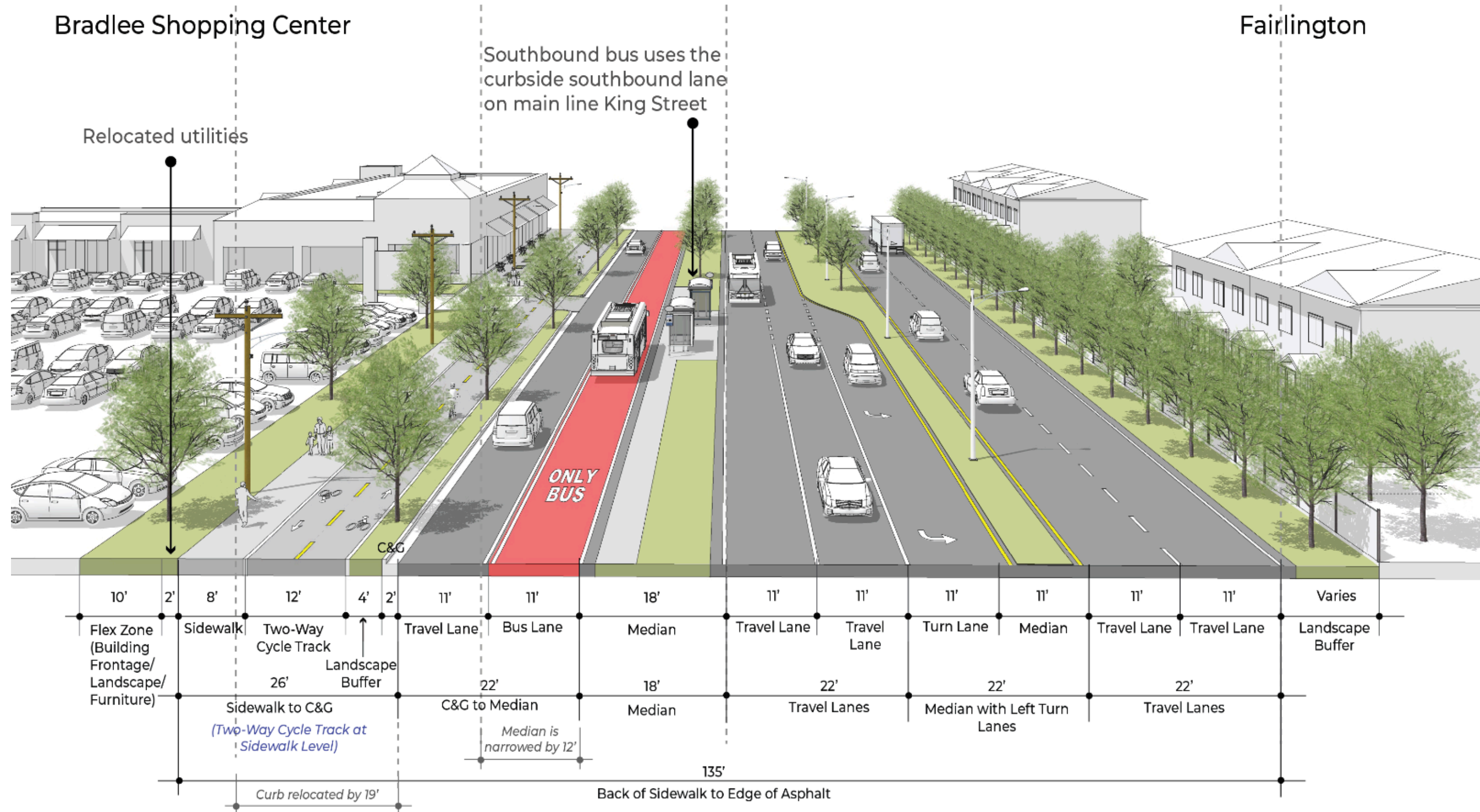

Alternative 3: One-Way Shared Traffic

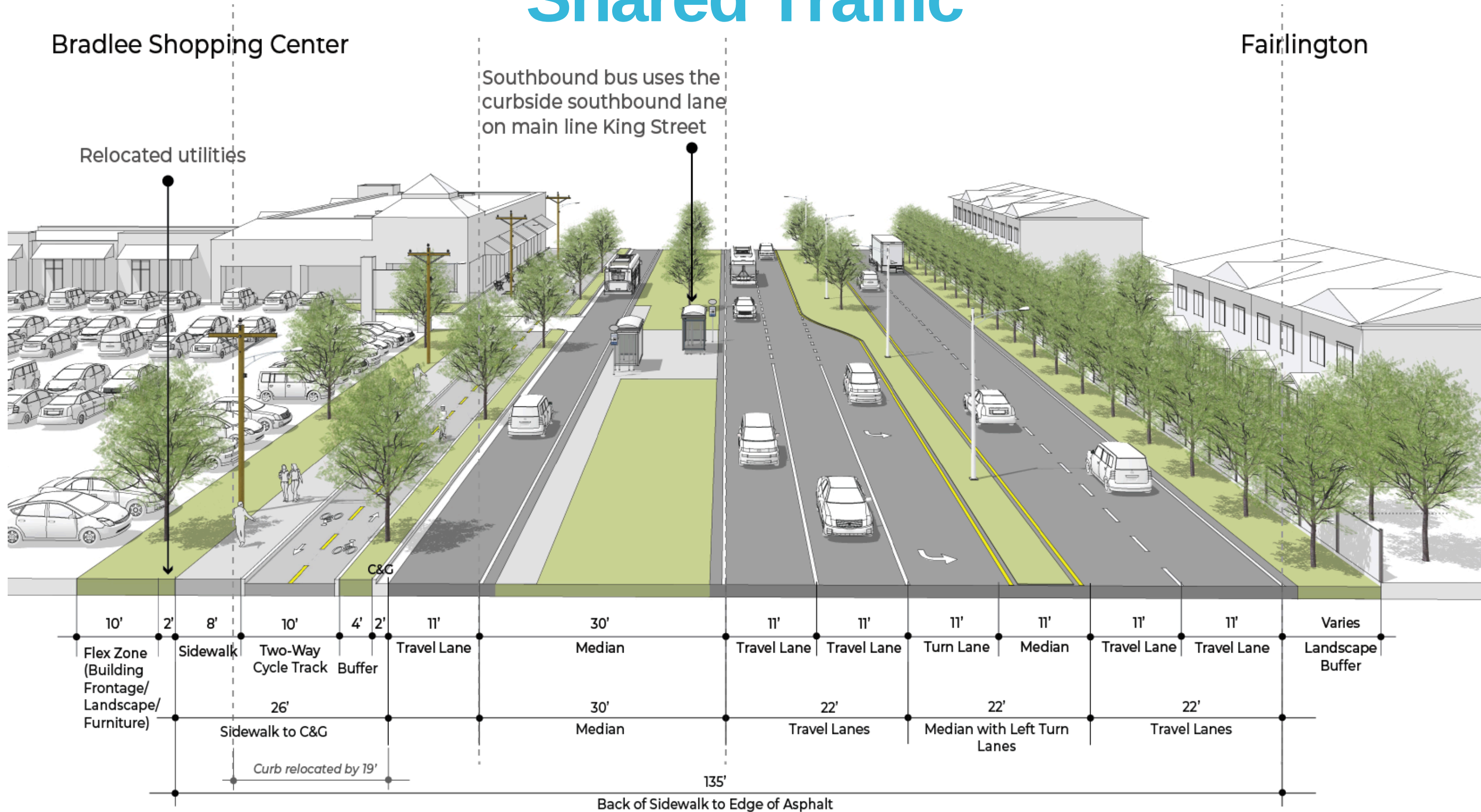

Full Corridor Design

Alternative 1: Two-Way Traffic with Transit

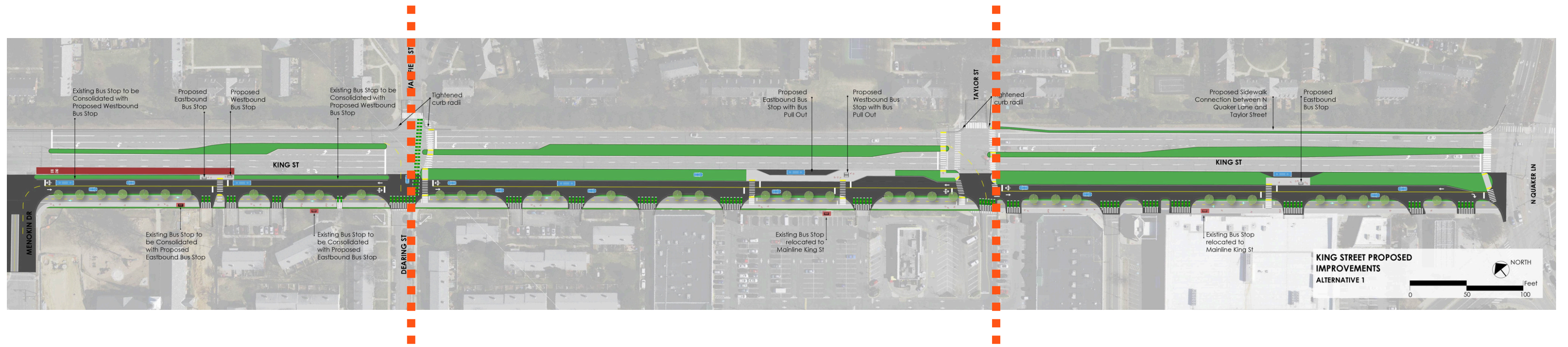

Menokin Dr

N. Dearing St

Taylor Street

N. Quaker Ln

Alternative 1: Two-Way Traffic with Transit

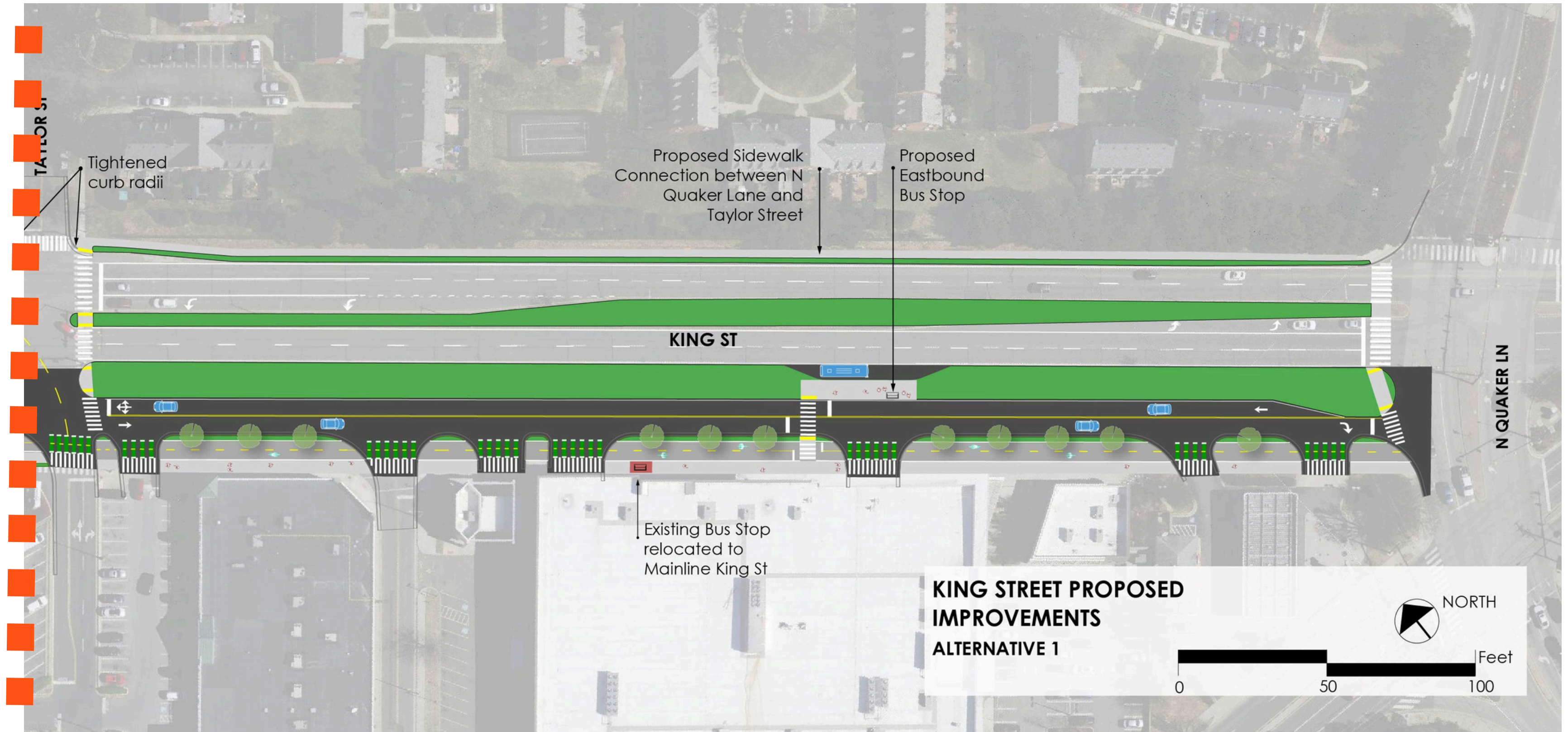

Taylor St

N. Quaker Ln

Alternative 1: Two-Way Traffic with Transit

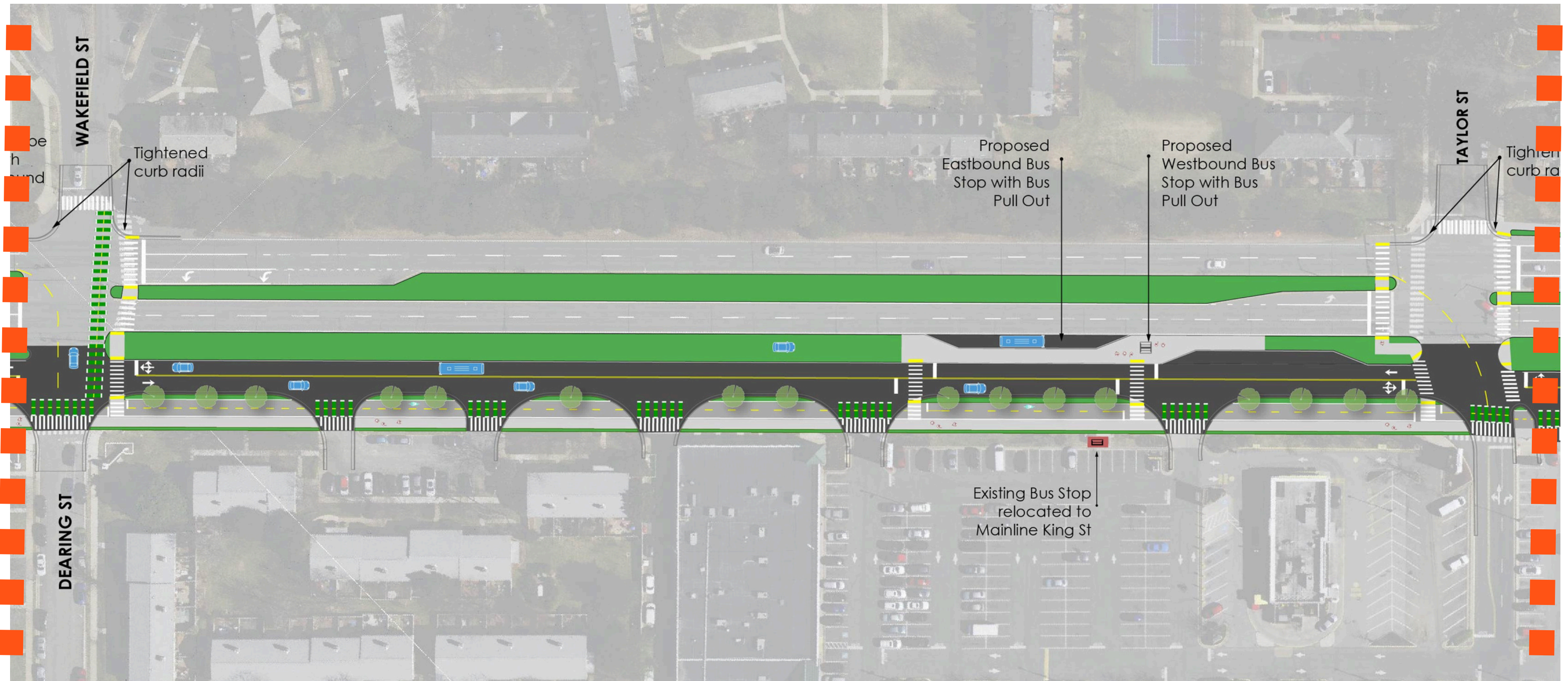

N. Dearing St

Taylor St

Alternative 1: Two-Way Traffic with Transit

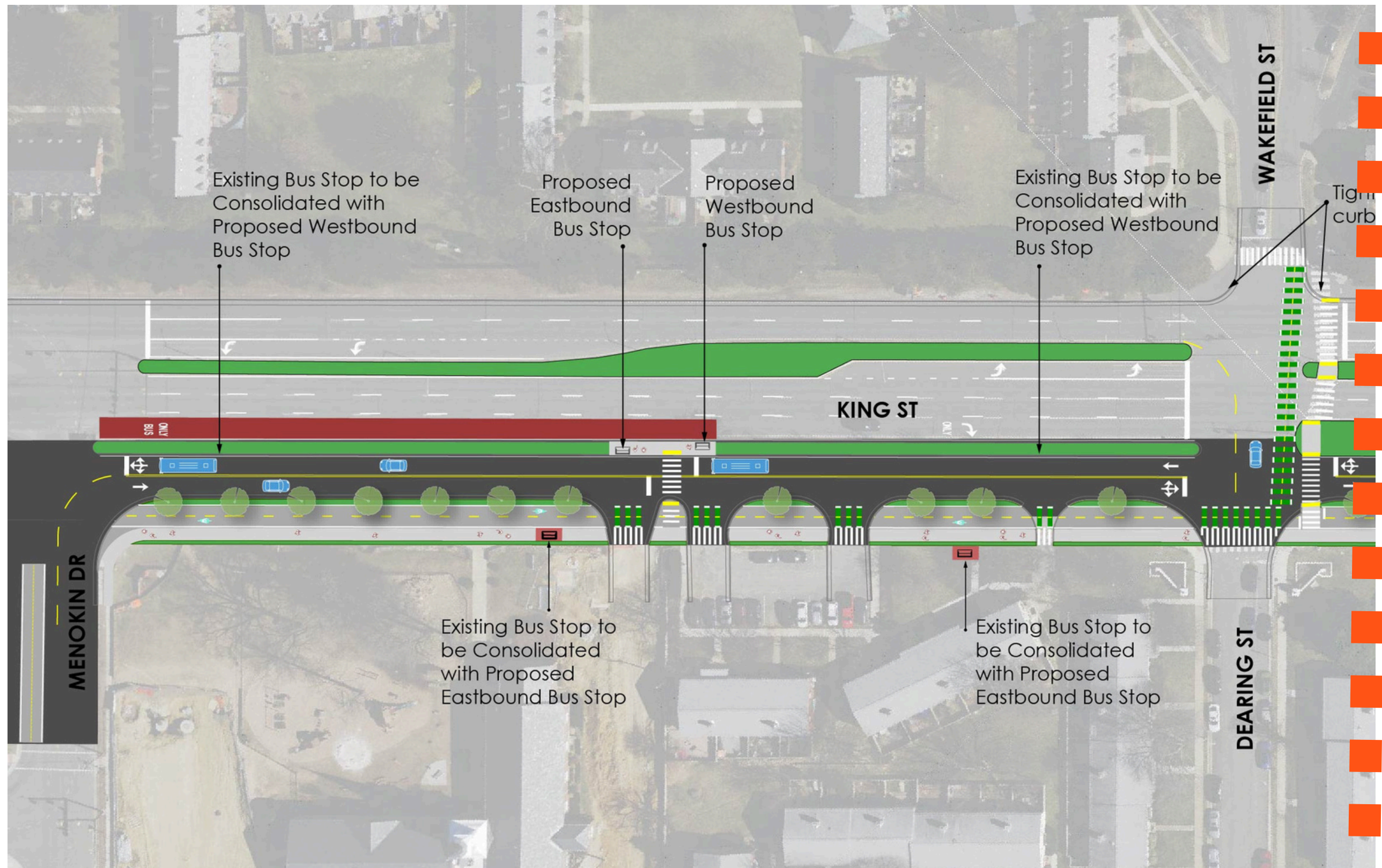

Menokin Dr

N. Dearing St

Alternative 2: One-Way Traffic & Bus Lane

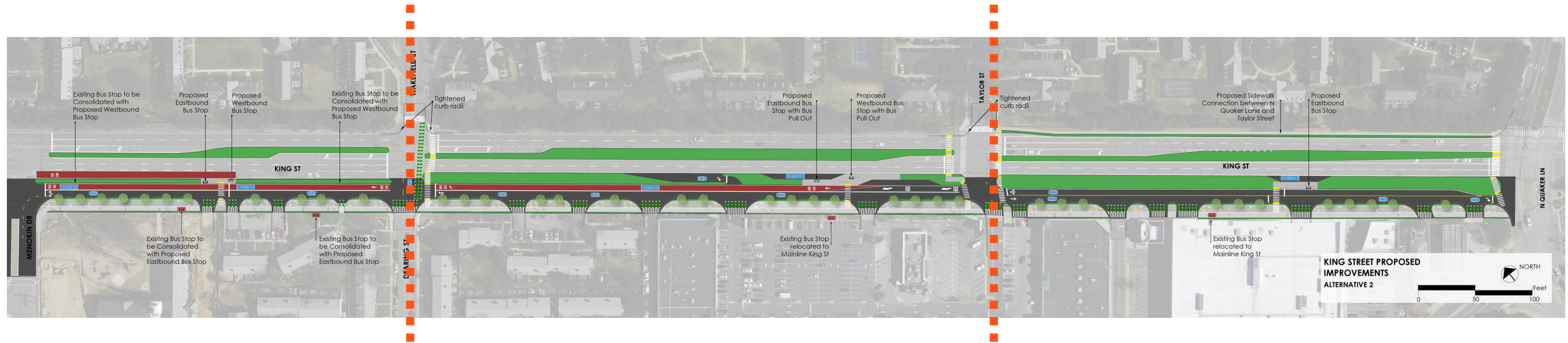

Menokin Dr

N. Dearing St

Taylor Street

N. Quaker Ln

Alternative 2: One-Way Traffic & Bus Lane

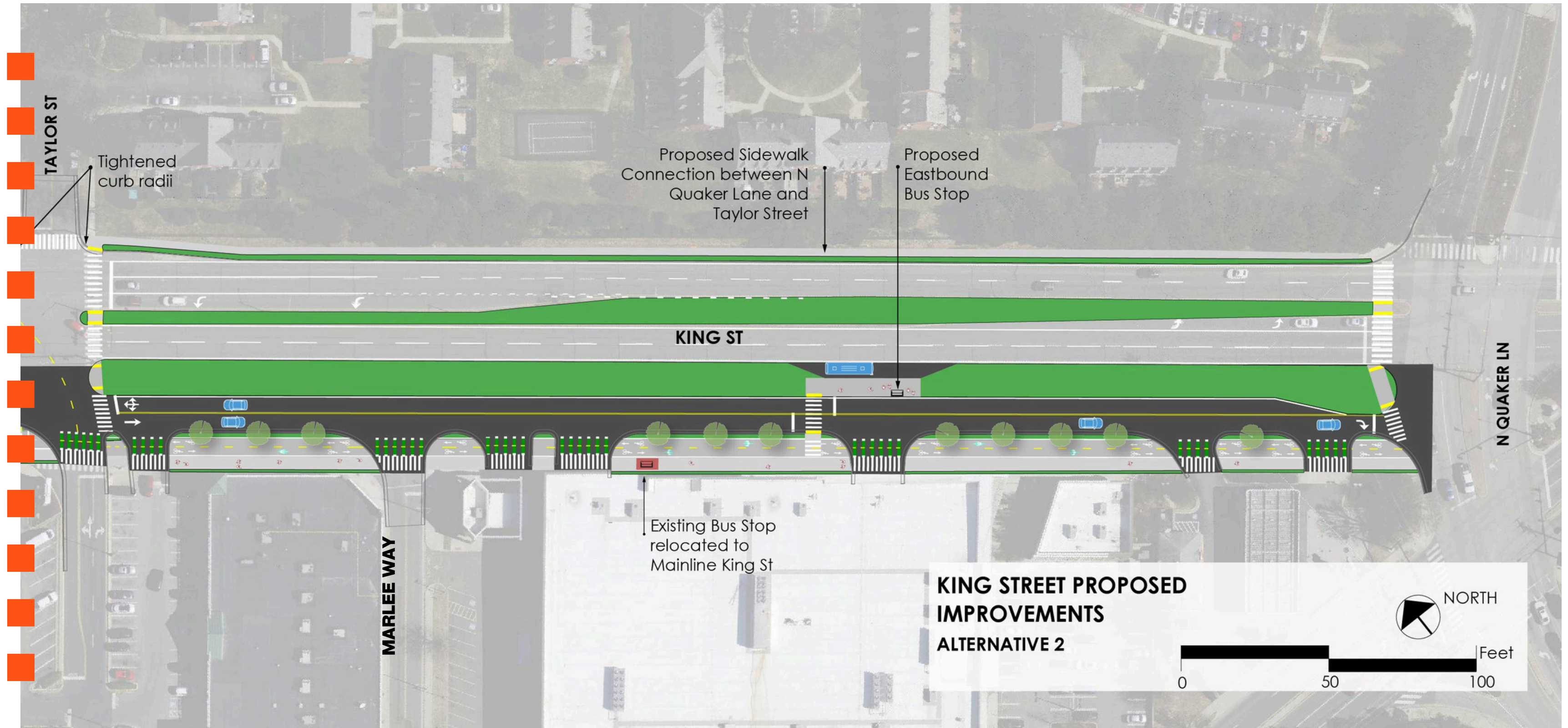

Taylor St

N. Quaker Ln

Alternative 2: One-Way Traffic & Bus Lane

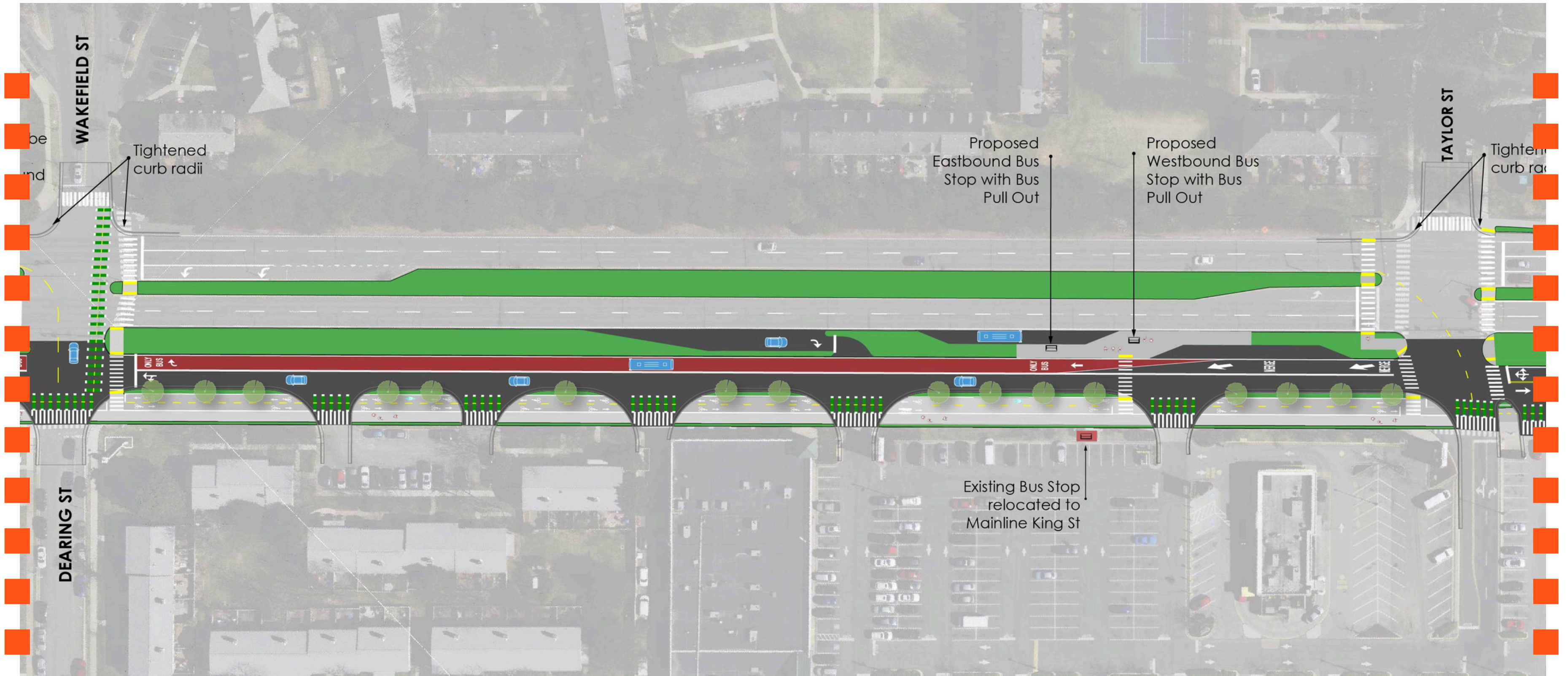

N. Dearing St

Taylor St

Alternative 2: One-Way Traffic & Bus Lane

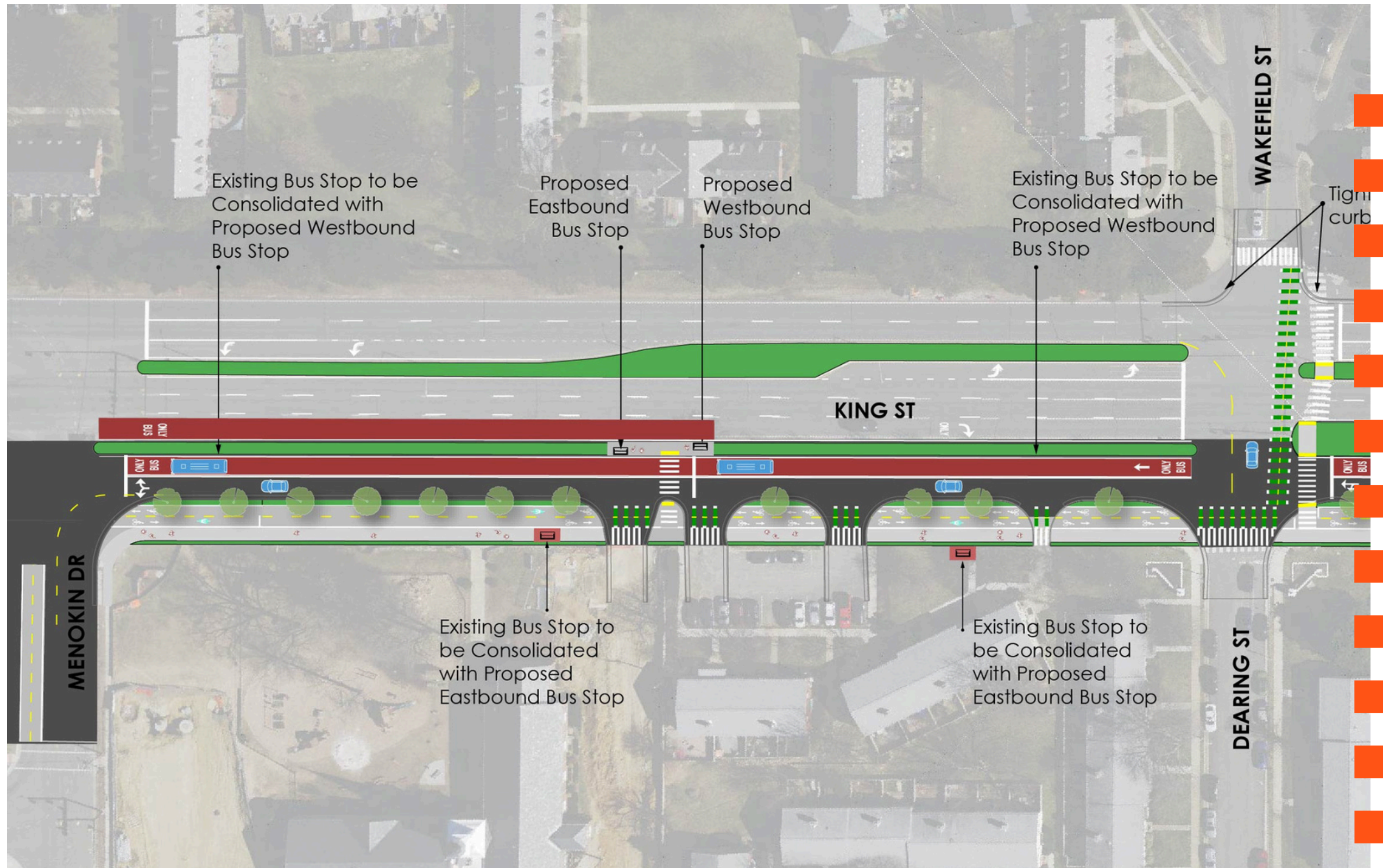

Menokin Dr

N. Dearing St

Community Feedback

Little support for Alternative 3

- Removed from consideration

Access to Safeway and Marlee Way

- Maintain two-way traffic on access road between S Taylor and Quaker

Vehicle Stacking to Bradlee

- Access point into shopping center

Right Turn Lane at North Dearing Street

- Right turn from westbound access road onto mainline King Street

Interim Improvements



- Speed feedback signs
- Curb radii tightening
- No Turn on Red signage
- Pavement markings at intersections



- Bicycle wayfinding signage
- Sharrow symbols
- Pedestrian refuge hardening
- Signal timing adjustments
- Safety improvements at bus shelters



- Tree planting in medians on King Street

Upcoming Activity





Questions & Comments



Sara Brandt-Vorel
Sara.BrandtVorel@AlexandriaVA.gov

Information Items

STAFF UPDATES

COMMISSIONER UPDATES